

MONARCH® 9415™ PRINTER ADDENDUM

This addendum contains information about cleaning the platen roller and printhead.

Note: Information in this document supercedes information in previous versions. Check our Web site (www.monarch.com) for the latest documentation and release information.

Audience

This addendum is for the person who prints and applies labels.

Cleaning the Platen Roller and Printhead

Clean the platen roller and printhead after every five rolls of labels or when you see voids in the print.

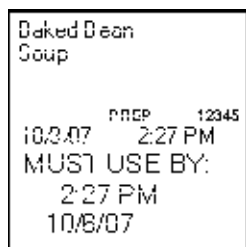

Voids

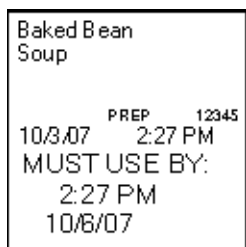

Correct Print

1. Remove any loaded labels.
2. Use a plastic knife to snap off the supply slot cover.

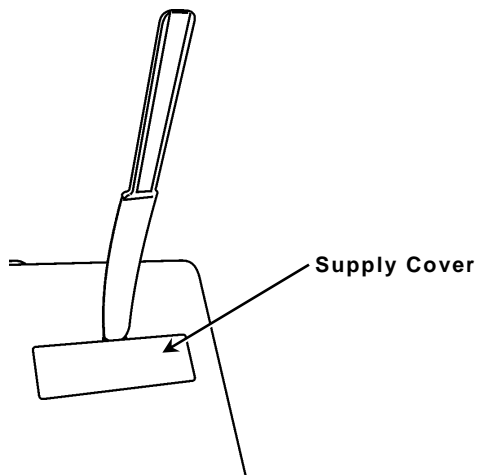

3. Use the plastic knife to press the L-shaped bar and the platen roller pops out.

Note: Art is cut-away to show detail.

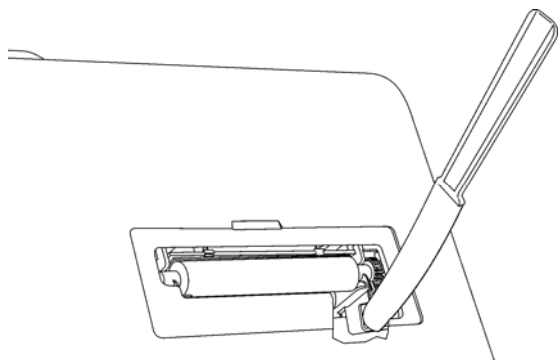

4. Clean the platen roller and printhead using a cotton swab moistened with isopropyl alcohol.
Caution: Do not use sharp or pointed objects to remove labels. It may damage the printer.

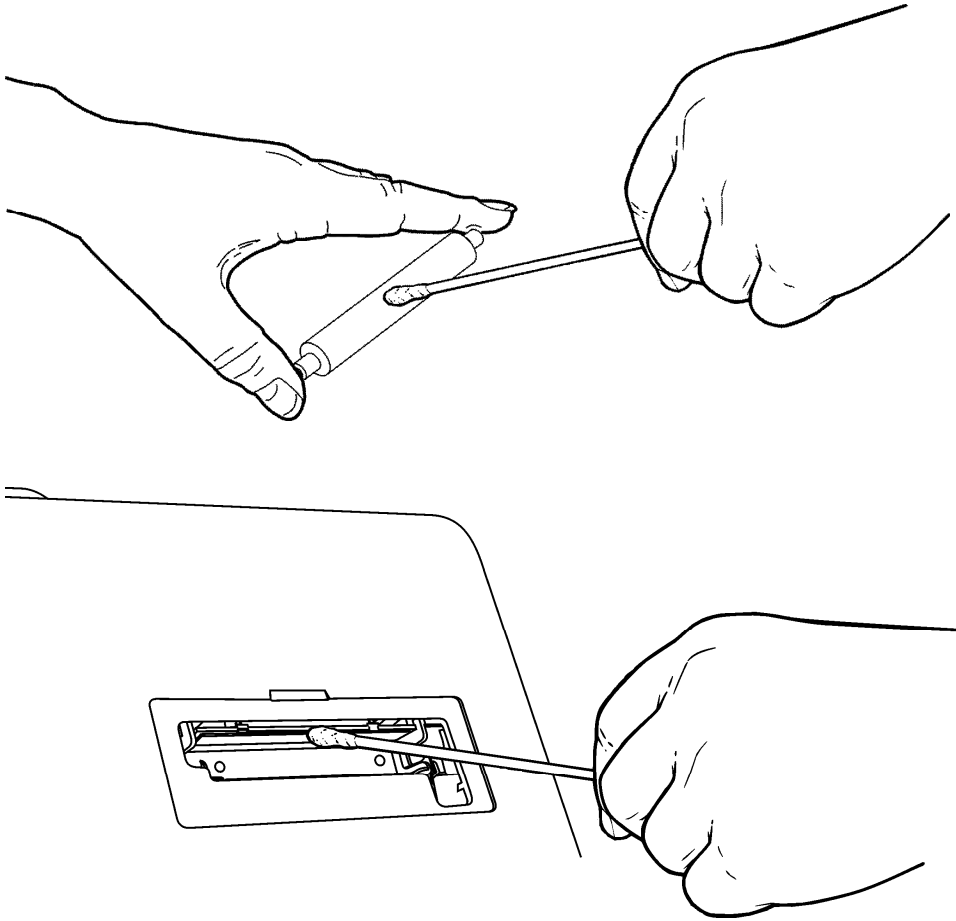

5. Allow time for the parts to dry.
6. Replace the platen roller.
7. Snap the cover into place.
8. Reload the labels. See the *Operator's Handbook* for more information.